

Product Information

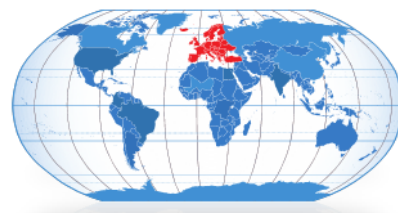

1305001

Sussex 63mm M12 Bolt Hole Castor - with cranked pin brake.

These castors are designed for display type applications and are not expected to travel large distances. The static load is 250kg and the dynamic rating would be expected to be the same over short distances only, on smooth floor conditions.

Pressed Steel Zinc Plated Fork

Pressed Steel zinc Plated top cap and cone with double ballrace swivel.

Nylon wheel with a roller bearing.



Technical Data

Wheel diameter	63mm
Wheel width	36mm
Hub width	39mm
Swivel radius	68mm
Body - colour	Zinc Plated
Wheel — colour	Black Grey
Brake	Cranked Pin
Load capacity (dynamic)	250Kg
Standard	ISO 22883

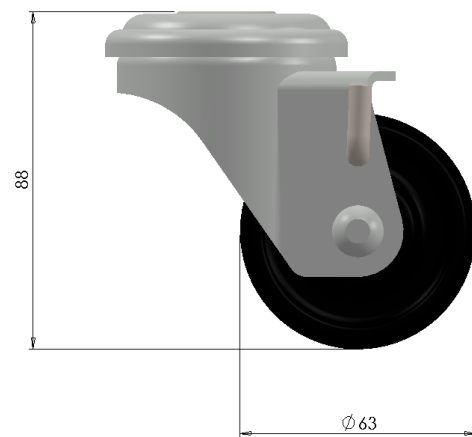
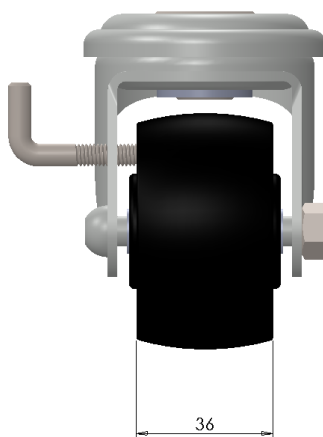

THE GLOBAL LEADER IN CASTORS AND WHEELS

Printed copies are uncontrolled, please refer to website for latest information www.colson-castors.co.uk

20/04/2015 Issue 1