

# Product Information

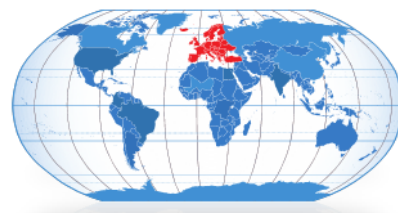

**2SL 050 NY0L**

## 50mm Low level twin wheel castor

Pressed Steel Zinc Plated Top Plate with 1/4" ball bearing for swivel.

Cast Iron Fork - painted aluminium

Nylon wheel with a plain bearing.

Fixings:- Four M6 countersink-head screws



## Technical Data

|                         |                                  |
|-------------------------|----------------------------------|
| Wheel diameter          | 50mm                             |
| Wheel tread width       | 14mm                             |
| Hub width               | N/A                              |
| Swivel radius           | 50mm                             |
| Offset                  | 19mm                             |
| Body - colour           | Zinc Plated /<br>Aluminium Paint |
| Wheel — colour          | Natural nylon                    |
| Tyre - colour           | N/A                              |
| Load capacity (dynamic) | 160Kg                            |
| Standard                |                                  |

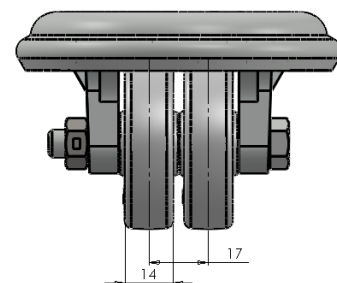
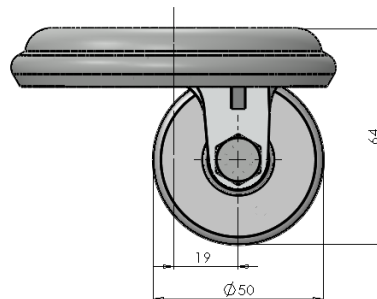
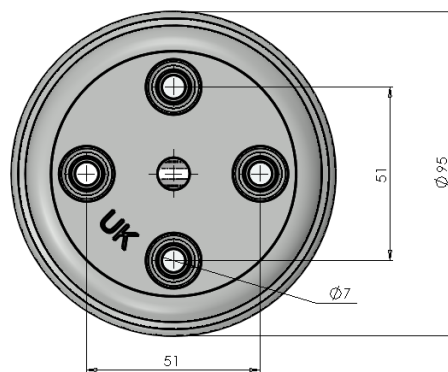

**THE GLOBAL LEADER IN CASTORS AND WHEELS**

Printed copies are uncontrolled, please refer to website for latest information [www.colson-castors.co.uk](http://www.colson-castors.co.uk)

20/04/2015 Issue 1